

**TYPICAL SECTION NO. 1**  
 MAP 1 - US 21 FROM 300' N. OF SR 1100 TO 500' S. OF SR 1121

PAVEMENT SCHEDULE	
F1*	LATEX MODIFIED MICROSUFACING, DOUBLE COURSE, TYPE III / TYPE III. APPLY THE LEVELING COURSE AT A MIN. RATE OF 20 LBS. PER SQ. YD. APPLY THE SURFACE COURSE AT AN AVG. RATE OF 20 TO 24 LBS. PER SQ. YD. THE COMBINED MIN. RATE SHALL BE 40 LBS. PER SQ. YD.
U	EXISTING PAVEMENT

\* NOTE: FIBERS INCLUDED AT RATE OF 0.2% - 0.4% OF DRY MATERIAL WEIGHT

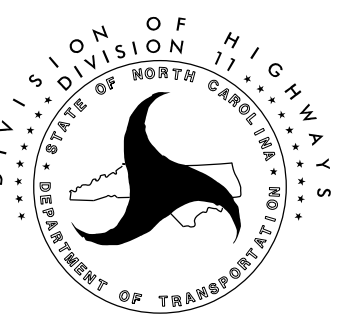
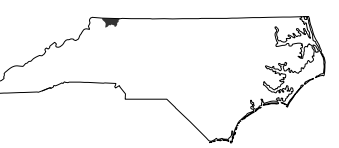

PROJECT NO.	SHEET NO.
DK00472	2

## SUMMARY OF QUANTITIES

PROJECT NO	COUNTY	MAP NO	ROUTE	DESCRIPTION	TYP NO	LANES	LANE TYPE	LENGTH	WIDTH	BEGIN MP	END MP	1220000000-E	1891000000-E	4413000000-E	4810000000-E		4895000000-N
												INCIDENTAL STONE BASE	GENERIC PAVING ITEM, MICROSURFACING DOUBLE COURSE TYPE III WITH FIBER	WORK ZONE ADVANCE/GENERAL WARNING SIGNING	4" WHITE PAINT	4" YELLOW PAINT	GENERIC PAVEMENT MARKING ITEM, POLYCARBONATE H- SHAPED MARKER
												TONS	SY	SF	LF	LF	EA
2026CPT.11.11.10031	Alleghany	1	US-21 N / US HWY 21 N	FROM PAVEMENT CHANGE 300" NORTH SR 1100 TO PAVEMENT CHANGE 500' SOUTH SR 1121	1	2	2WU	9.540	26	1.640	11.180	50	145,517	462	111,000	111,000	668
<b>TOTAL FOR PROJ NO. 2026CPT.11..11.10031</b>								<b>9.540</b>				<b>50</b>	<b>145,517</b>	<b>462</b>	<b>111,000</b>	<b>111,000</b>	<b>668.000</b>
															<b>422,960</b>		
<b>GRAND TOTAL</b>								<b>9.540</b>				<b>50</b>	<b>145,517</b>	<b>462</b>	<b>111,000</b>	<b>111,000</b>	<b>668.000</b>
															<b>222,000</b>		

[MILE POST MAPS](#)

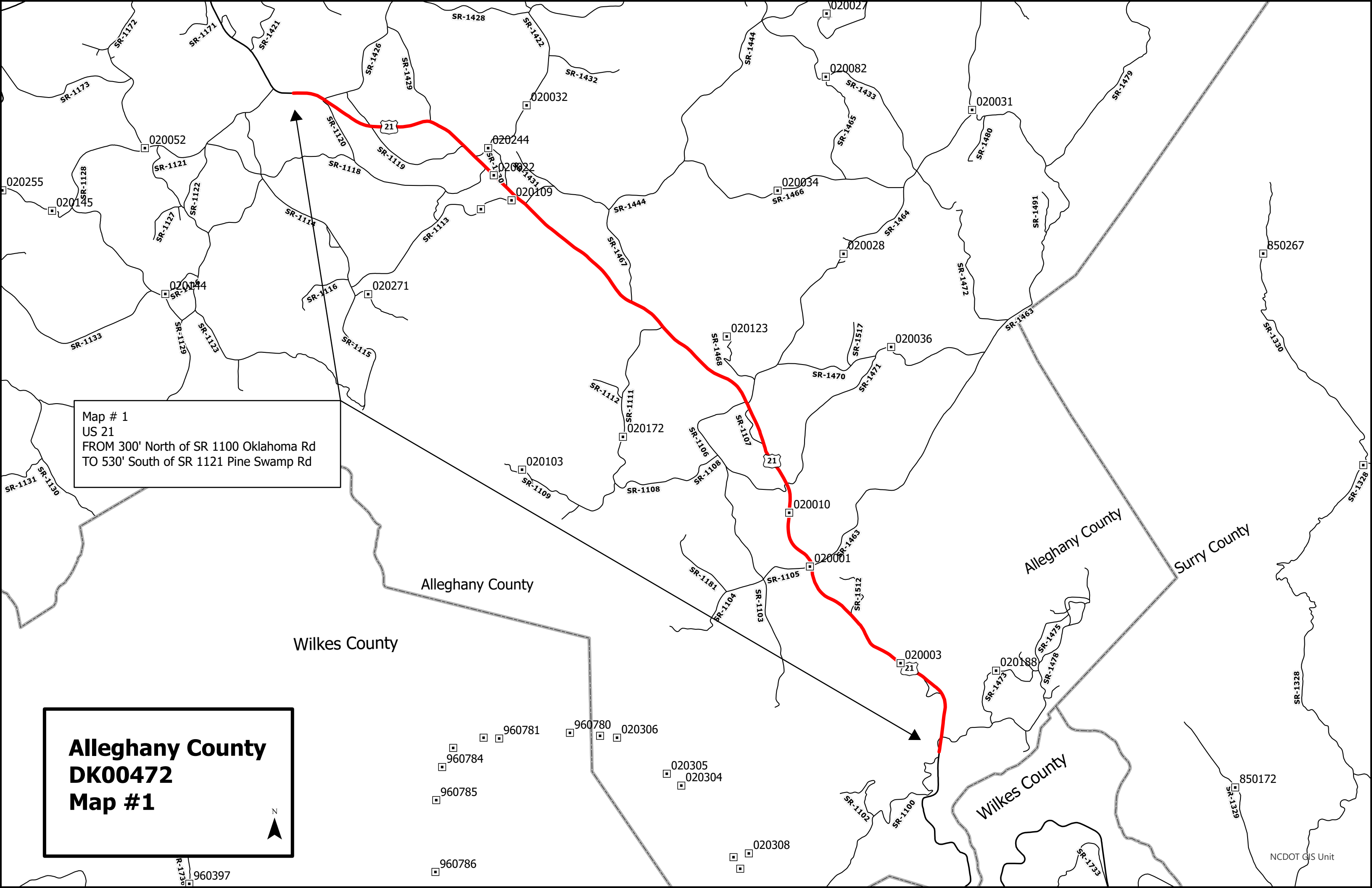

Map # 1  
US 21  
FROM 300' North of SR 1100 Oklahoma Rd  
TO 530' South of SR 1121 Pine Swamp Rd

**Allegheny County**  
**DK00472**  
**Map #1**



# SIGNING FOR RESURFACING PROJECTS

**LEGEND**  
 ┆ STATIONARY SIGN  
 ← DIRECTION OF TRAFFIC FLOW

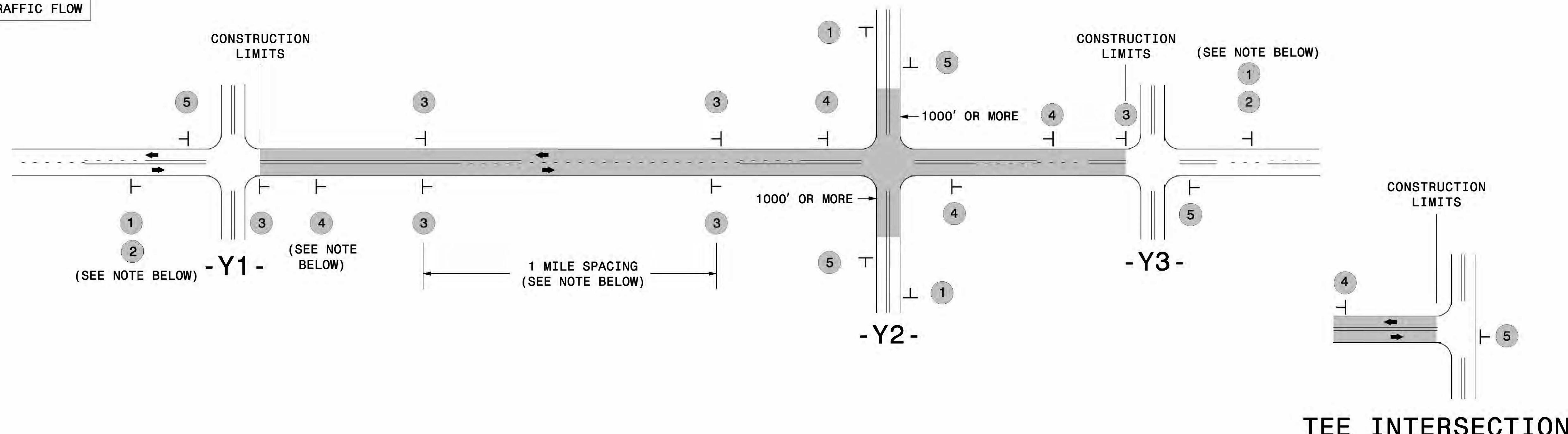

## MAINLINE (-L-) SIGNING

## -Y- LINE SIGNING

SIGNING NOTES AND PLACEMENT PER DIRECTION	1	 W20-1 48" X 48"	PLACE 1000' PRIOR TO BEGINNING OF CONSTRUCTION LIMITS. ONLY USED ON -Y- LINES IF RESURFACING LIMITS EXTEND 1000' ALONG -Y- LINE.	<p>NO REQUIRED STATIONARY SIGNING FOR THE FOLLOWING -Y- LINE CONDITIONS:</p> <ol style="list-style-type: none"> <li>1) LESS THAN 1000' OF RESURFACING ALONG -Y- LINE</li> <li>2) SUBDIVISION ROADS</li> <li>3) DEAD END ROADS</li> </ol> <p>WHEN PAVING/CONSTRUCTION ACTIVITIES PROCEED ACROSS AN UNSIGNED -Y- LINE, PORTABLE ADVANCE WARNING SIGNS SHALL BE USED ALONG THE -Y- LINE AS SHOWN BELOW. REMOVE UPON COMPLETION OF WORK.</p> <div style="display: flex; justify-content: space-around;"> <div style="text-align: center;">             W20-1            48" X 48"            PLACED 500' IN ADVANCE OF FLAGGER.         </div> <div style="text-align: center;">             W20-7 A            48" X 48"            PLACED 250' IN ADVANCE OF FLAGGER.         </div> </div>
	2	 W7-3aP 24" X 18"	#2 SIGN ONLY USED WHEN CONSTRUCTION LIMITS ARE 2 OR MORE MILES IN LENGTH. ROUND UP TO NEXT WHOLE NUMBER. (NO FRACTIONAL OR DECIMAL NUMBERS)	
	3	 SP 13107 48" X 48"	<ul style="list-style-type: none"> <li>- PLACE INITIALLY AT THE CONSTRUCTION LIMITS AND SPACE 1 MILE APART THEREAFTER.</li> <li>- AT TEE INTERSECTIONS INSTALL INITIALLY 1/2 MILE FROM INTERSECTION AND SPACE 1 MILE APART THEREAFTER.</li> </ul>	
	4	 SP 13106 48" X 48"	<ul style="list-style-type: none"> <li>- THESE ARE FOR -Y- LINES THAT ARE "THROUGH" ROADWAYS.</li> <li>- DEAD END AND SUBDIVISION ROADS ARE NOT "THROUGH" ROADWAYS.</li> <li>- INSTALL 500' +/- FROM EACH -Y- LINE APPROACH AS SHOWN ABOVE.</li> <li>- FOR MULTIPLE -Y- LINES THAT ARE SEPARATED BY 0.25 MILES OR LESS, TREAT AS A SINGLE UNIT AND INSTALL WITHIN 500' OF EACH APPROACH.</li> <li>- A MAXIMUM OF 2 SIGN SETS PER MILE. DO NOT INSTALL WHEN -Y- LINES ARE WITHIN 0.5 MILES FROM "END ROAD WORK" SIGN.</li> <li>- FOR TEE INTERSECTIONS, INSTALL WITHIN 500' +/- OF THE INTERSECTION ALONG -L- LINE.</li> </ul>	
	5	 G20-2 A 48" X 24"	PLACE 500' FOLLOWING THE END OF CONSTRUCTION LIMITS OR AS SHOWN WHEN WORK ENDS AT A 3-WAY TEE INTERSECTION.	

THE ABOVE SIGNS ARE ALL THAT ARE REQUIRED FOR A CONTRACTOR TO BEGIN A RESURFACING CONTRACT. ANY ADDITIONAL SIGNS REQUESTED BY NCDOT DIVISIONS SHALL BE INSTALLED WITHIN 7 BUSINESS DAYS OF THE START OF CONTRACT WORK.

### MAPS LESS THAN 2 MILES

FOR RESURFACING MAPS WITH CONSTRUCTION LIMITS LESS THAN 2 MILES IN LENGTH, NO STATIONARY SIGNS ARE REQUIRED. USE PORTABLE "ROAD UNDER CONSTRUCTION" OR "ROAD WORK AHEAD" SIGNS IN LIEU OF STATIONARY ADVANCE WARNINGS SIGNS.

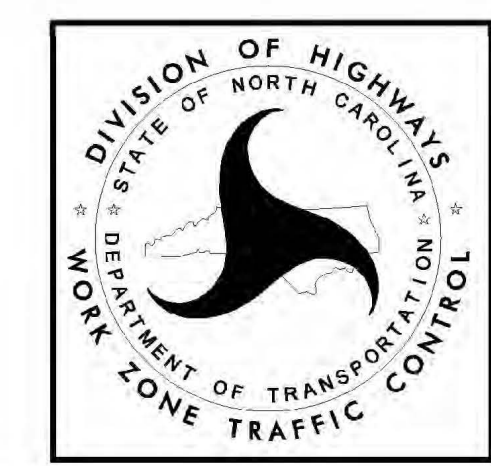

**ADVANCE WARNING SIGNS FOR RURAL AND SUBURBAN 2-LANE ROADWAY RESURFACING**

5/15/2017 5:11 PM \\MDX\ITC\Resurfacing\Details\Resurfacing\_AdvWarn\_2Ln.dgn User:keals